

ESECUZIONE  
ANTIDEFAGRANTECE 0722 Ex II 2GD Ex d IIC Ex tD A21 IP 66/67  
CE 0722 Ex II 2GD Ex e II Ex tD A21 IP 66/67EX  
CODE

CERTIFICAZIONE



CESI 02 ATEX 049 (Elfit)

CERTIFICATE



IECEX



( AUSTRALIAN - GOST R )

DIRETTIVA

94/9/CE

DIRECTIVE

NORME

EN 60079-0 - EN 60079-1 - EN 60079-7 - EN 60529 - EN 61241-1 - EN 61241-0

STANDARDS

INSTALLAZIONE (secondo le EN 60079.14)

zona 1 - 2 - 21 - 22

(according to EN 60079.14) INSTALLATION

## CARATTERISTICHE

I tappi della serie PLG vengono utilizzati per la chiusura di ingressi inutilizzati e sono costruiti con testa esagonale incassata per garantire la possibilità di apertura solo con attrezzi appositi.

## FEATURES

PLG series plugs are used to close the unused entries. They have an hexagonal head so that they can be opened with proper tools only.

## COSTRUZIONE

Con esagono incassato per tappi con filettatura conica, con esagono esterno per tappi con filettatura cilindrica.

## CONSTRUCTION

With rabbeted hexagon for plugs with tapered thread, with external hexagon for plug with cylindrical thread.

## ACCESSORI A RICHIESTA

Altre filettature.  
Atri materiali.

## ACCESSORIES UPON REQUEST

Other threads.  
Other materials.

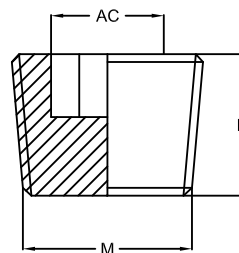

| Codice<br>Code | Filettatura ISO 7/1<br>ISO 7/1 thread<br>M | Dimensioni<br>Dimensions |    | Materiale<br>Material              | Peso<br>Weight<br>Kg | Prezzo<br>Price |
|----------------|--|--------------------------|----|------------------------------------|----------------------|-----------------|
|                |  | AC                       | H  |                                    |                      |                 |
| PLG02G         | 1/4"                                       | 8                        | 14 | Acciaio zincato - Galvanized steel | 0,014                |                 |
| PLG01G         | 3/8"                                       | 8                        | 14 | Acciaio zincato - Galvanized steel | 0,024                |                 |
| PLG1G          | 1/2"                                       | 13                       | 18 | Acciaio zincato - Galvanized steel | 0,034                |                 |
| PLG2G          | 3/4"                                       | 17                       | 18 | Acciaio zincato - Galvanized steel | 0,054                |                 |
| PLG3G          | 1"   | 19                       | 24 | Acciaio zincato - Galvanized steel | 0,124                |                 |
| PLG4A          | 1 1/4"                                     | 24                       | 24 | Alluminio - Aluminium              | 0,061                |                 |
| PLG5A          | 1 1/2"                                     | 35                       | 24 | Alluminio - Aluminium              | 0,063                |                 |
| PLG6A          | 2"   | 36                       | 24 | Alluminio - Aluminium              | 0,109                |                 |
| PLG7A          | 2 1/2"                                     | 50                       | 30 | Alluminio - Aluminium              | 0,169                |                 |
| PLG8A          | 3"   | 50                       | 30 | Alluminio - Aluminium              | 0,242                |                 |
| PLG10A         | 4"   | 85                       | 30 | Alluminio - Aluminium              | 0,489                |                 |
| PLG12A         | 5"   | 102                      | 32 | Alluminio - Aluminium              | 0,735                |                 |
| PLG14A         | 6"   | 119                      | 32 | Alluminio - Aluminium              | 1,00                 |                 |

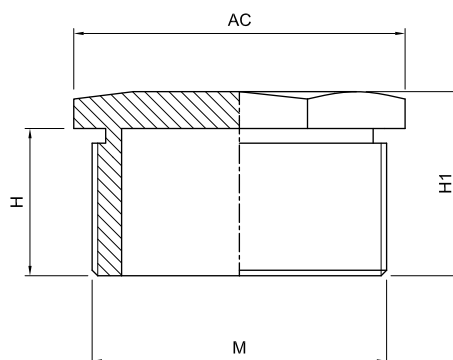

| Codice<br>Code | Filettatura<br>Thread<br>M | AC  | Dimensioni<br>Dimensions |    | Materiale<br>Material    | Peso<br>Weight<br>Kg | Prezzo<br>Price |
|----------------|----------------------------|-----|--------------------------|----|--------------------------|----------------------|-----------------|
|                |                            |     | H                        | H1 |                          |                      |                 |
| PLG02C..       | 1/4" UNI ISO 228           | 17  | 16                       | 21 | A richiesta / on request | 0,014                |                 |
| PLG01C..       | 3/8" UNI ISO 228           | 22  | 16                       | 21 | A richiesta / on request | 0,024                |                 |
| PLG1C..        | 1/2" UNI ISO 228           | 25  | 20                       | 25 | A richiesta / on request | 0,034                |                 |
| PLG2C..        | 3/4" UNI ISO 228           | 32  | 20                       | 25 | A richiesta / on request | 0,054                |                 |
| PLG3C..        | 1" UNI ISO 228             | 38  | 24                       | 29 | A richiesta / on request | 0,124                |                 |
| PLG4C..        | 1 1/4" UNI ISO 228         | 45  | 24                       | 29 | A richiesta / on request | 0,061                |                 |
| PLG5C..        | 1 1/2" UNI ISO 228         | 55  | 24                       | 29 | A richiesta / on request | 0,063                |                 |
| PLG6C..        | 2" UNI ISO 228             | 65  | 24                       | 29 | A richiesta / on request | 0,109                |                 |
| PLG7C..        | 2 1/2" UNI ISO 228         | 85  | 24                       | 29 | A richiesta / on request | 0,169                |                 |
| PLG8C..        | 3" UNI ISO 228             | 100 | 24                       | 29 | A richiesta / on request | 0,242                |                 |
| PLG10C..       | 4" UNI ISO 228             | 120 | 24                       | 29 | A richiesta / on request | 0,489                |                 |
| PLG01I..       | M16 ISOMETRICA             | 20  | 16                       | 21 | A richiesta / on request | 0,014                |                 |
| PLG1I..        | M20 ISOMETRICA             | 24  | 16                       | 21 | A richiesta / on request | 0,024                |                 |
| PLG2I..        | M25 ISOMETRICA             | 30  | 16                       | 21 | A richiesta / on request | 0,034                |                 |
| PLG3I..        | M32 ISOMETRICA             | 36  | 16                       | 21 | A richiesta / on request | 0,054                |                 |
| PLG4I..        | M40 ISOMETRICA             | 46  | 16                       | 21 | A richiesta / on request | 0,124                |                 |
| PLG5I..        | M50 ISOMETRICA             | 55  | 16                       | 21 | A richiesta / on request | 0,061                |                 |
| PLG6I..        | M63 ISOMETRICA             | 70  | 18                       | 23 | A richiesta / on request | 0,063                |                 |
| PLG7I..        | M75 ISOMETRICA             | 85  | 18                       | 23 | A richiesta / on request | 0,109                |                 |

## Note:

| Materiale   | Esempio codice | Material  | Code example |
|-------------|----------------|-----------|--------------|
| Acciaio AVP | PLG3CG         | AVP Steel | PLG3CG       |
| Ottone      | PLG3CB         | Brass     | PLG3CB       |
| AISI316L    | PLG3CS         | AISI316L  | PLG3CS       |
| Alluminio   | PLG3CA         | Aluminium | PLG3CA       |

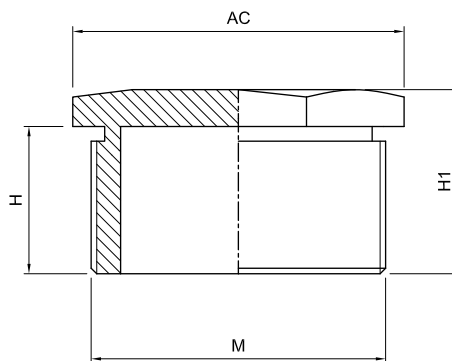

| Codice<br>Code | Filettatura ISO<br>ISO Thread<br>M | AC | Dimensioni<br>Dimensions |    | Materiale<br>Material  | Peso<br>Weight<br>Kg | Prezzo<br>Price |
|----------------|------------------------------------|----|--------------------------|----|------------------------|----------------------|-----------------|
|                |                                    |    | H                        | H1 |                        |                      |                 |
| PLG02IXEP      | 12                                 | 15 | 10                       | 15 | Poliammide / polyamide | 0,002                |                 |
| PLG01IXEP      | 16                                 | 19 | 12                       | 16 | Poliammide / polyamide | 0,003                |                 |
| PLG1IXEP       | 20                                 | 23 | 15                       | 21 | Poliammide / polyamide | 0,005                |                 |
| PLG2IXEP       | 25                                 | 28 | 15                       | 21 | Poliammide / polyamide | 0,007                |                 |
| PLG3IXEP       | 32                                 | 36 | 15                       | 23 | Poliammide / polyamide | 0,012                |                 |
| PLG4IXEP       | 40                                 | 46 | 18                       | 26 | Poliammide / polyamide | 0,024                |                 |
| PLG5IXEP       | 50                                 | 55 | 18                       | 27 | Poliammide / polyamide | 0,035                |                 |
| PLG6IXEP       | 63                                 | 69 | 18                       | 28 | Poliammide / polyamide | 0,051                |                 |